

GP Component

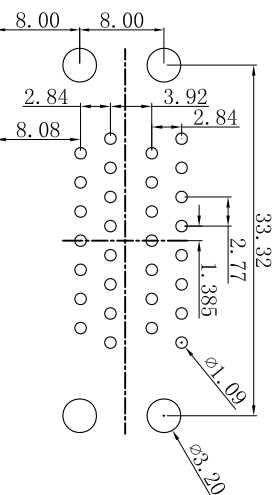

Specification Type (1: 2)

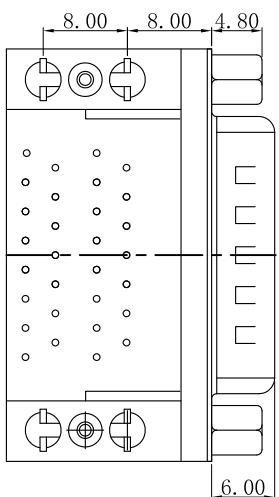
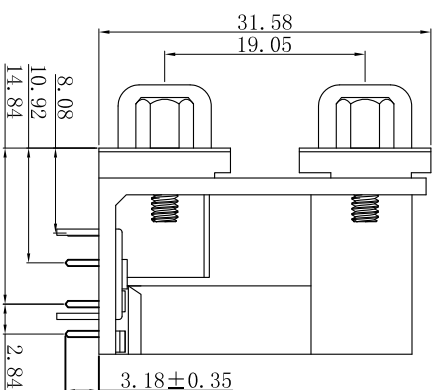
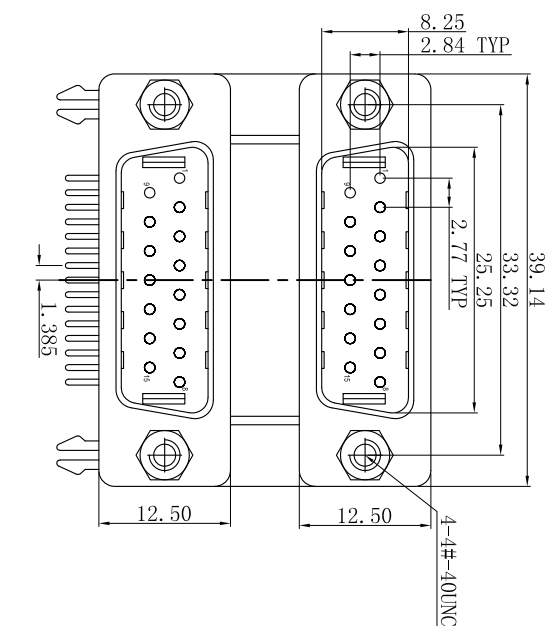
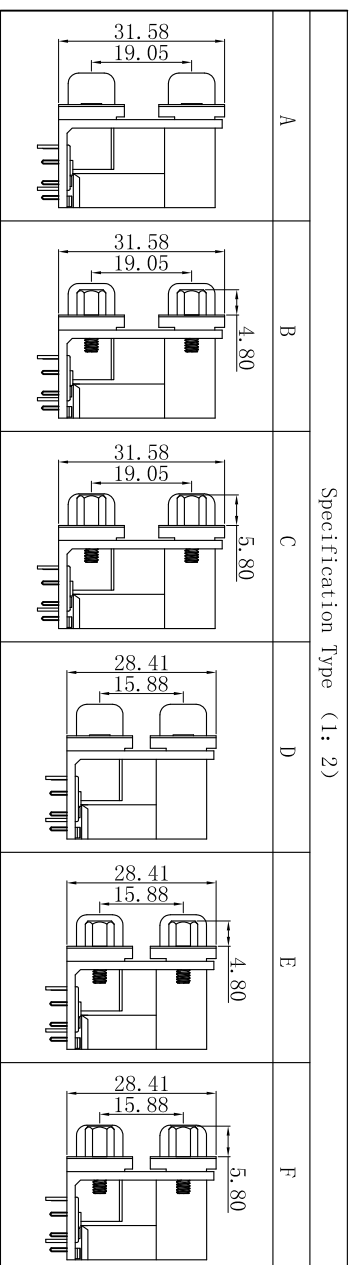

REV.	ECN NO.	LOCATIONS	DESCRIPTION	DATE	DESIGN
AO			原始版本(INITIAL EDITION)	2020.12.30	m t

- CHARACTERISTICS:
1. RATED VOLTAGE: 250V
 2. RATED CURRENT: 3 AMP
 3. CONTACT RESISTANCE: 30mΩ MAXIMUM
 4. INSULATION RESISTANCE: 1000 mΩ MINIMUM AT DC 500V
 5. ELECTRIC PRESSURE: KEEPING 60 SECOND IN AC 500V/1mA
 6. OPERATING TEMPERATURE: -55° C TO 105° C
 7. INSERTION/EXTRACTION FORCE PER CONTACT: 5.0 KG MAXIMUM 0.45KG MINIMUM

01.151530 M X XXX XX B XXX

PIN Poles 30:30PIN

M/F Differentiates M=Male F=Female

Hsg Color 1=Black 3=Blue 5=Yellow 2=White 4=Green 6=Purple

Plating G00:Gold Flash G01:Gold 1U" G03:Gold 3U" Gxx:Gold XXU"

B00:Bright sn B01:Bright sn 1U" B03:Bright sn 3U" Bxx:Bright sn XXU"

M00:Matte sn M01:Matte sn 1U" M03:Matte sn 3U" Mxx:Matte sn XXU"

Water Code

Specification Type

Hsg Material H1=PB1 HF H2=PA6T HF H3=PA9T HF H4=PA66 HF H5=LCP H6=PB1 HF H7=PA6T HF H8=PA9T HF H9=PA66 HF H10=PB1 HF H11=PA6T HF H12=PA9T HF H13=PA66 HF H14=PA6T HF H15=PA9T HF



东莞市跃展精密连接器有限公司
Dongguan YueZhan Precision Connectors Co., Ltd

UNITS: mm [inch]	DESIGN: 4 稿 2020.12.30	PART NAME: 双层DR15W-DR15M系列图
TOLERANCE: X.X ±0.35 X.XX ±0.25 X.XXX ±0.15 Angle ±3.0°	CHECKED: 4 稿 2020.12.30	PART NO. 01.151530MXXXXXXBXXX
SCALE:1:1 SIZE:A4	APPROVED: 4 稿 2020.12.30	DRAW NO.
		SHEET NO. 01 OF 01